



Step by Step

How To

Change Picture Size

This How To article explains how to change the size of pictures in reports

For a complete list of available How To documents visit the Support section of our website: www.inspectaride.com/support/

HOW TO: CHANGE PICTURE SIZE

You can choose between 3 different sizes for the pictures in your reports. Below are the steps to do this.

1. The first step is to login to the InspectARide portal. This is done by entering your username and password here: <https://www.inspectaride.com/login>



2. Once logged in, go to 'Settings'.

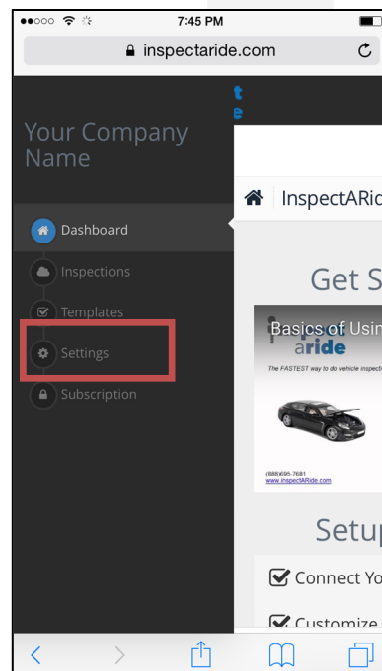

HOW TO: CHANGE PICTURE SIZE

- Next, locate the option for 'Picture Size'. By default it is set to 'Medium (3 Columns)'. You can change this to either 'Large (2 Columns)' or 'Small (4 Columns)'. Choose the option you'd like.

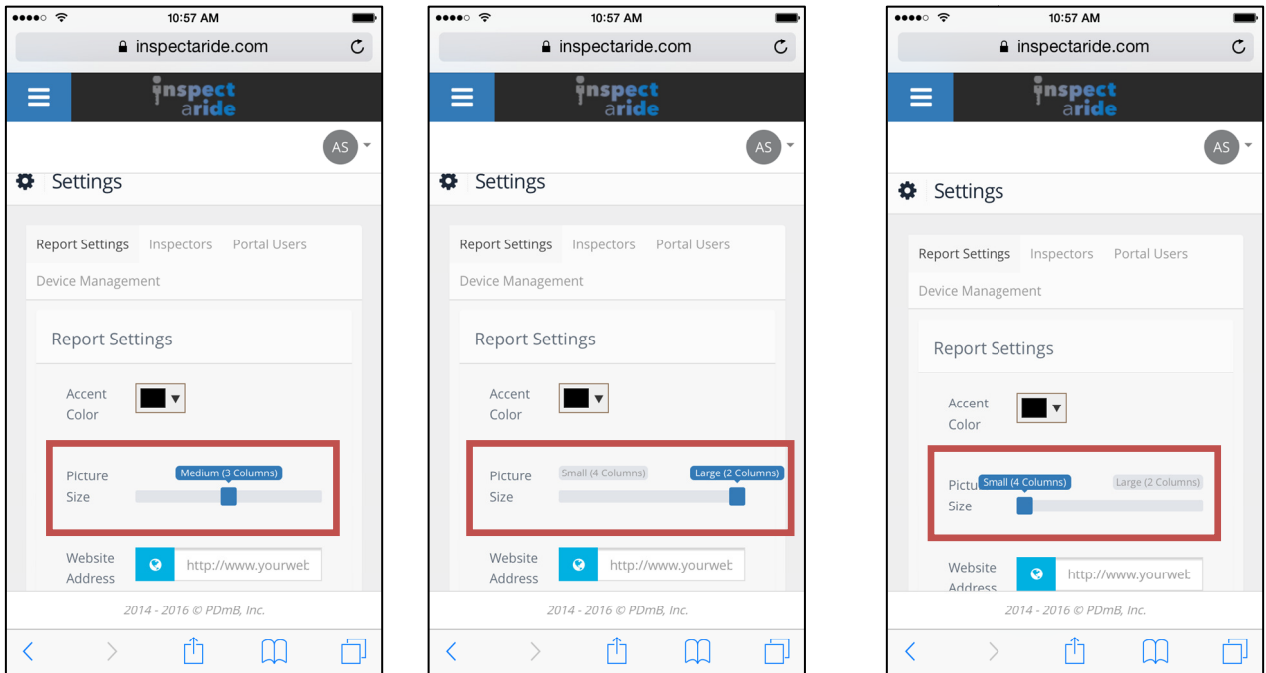

- The picture size will now be changed.